

Best Practices for Effective Online Course Design: *Session 3*

Center for Teaching Advancement and
Assessment Research



Agenda

1. Brief review
2. Results of Survey
3. Welcome to BigBlueButton
 - a. Breakout Room Activity
4. Poll Everywhere as Polling Tool
5. Videos and Kaltura
6. Playposit
7. Additional Resources
8. Discussion

Housekeeping: Conferences



- You won't be able to turn on your video in the main room (but you can in the breakout rooms)
- To the top left you will see the “Public Chat” click to view chat

- Click on your name to “Set status” and let us know how everything is going

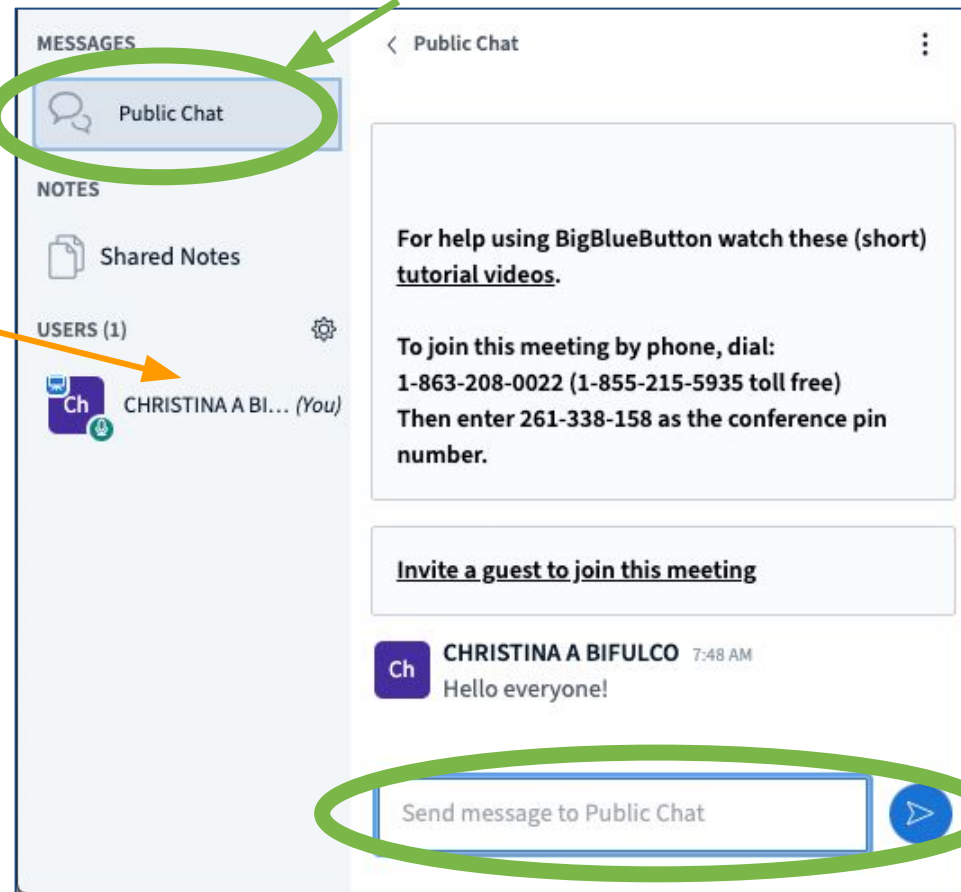
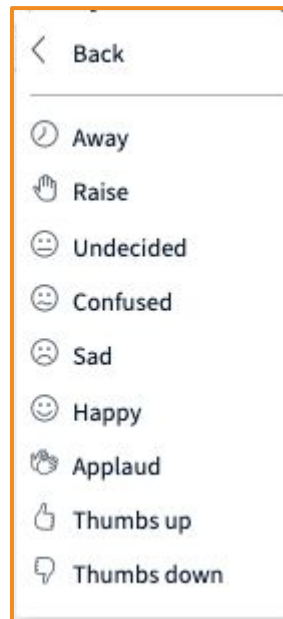

Housekeeping: BigBlueButton



- If the microphone is Blue your audio is on and everyone can hear you.
- Please mute your mic during the presentation but feel free to un-mute if you have a question or type in the chat
- If you didn't set up your audio when you came in **click the mic** to do that

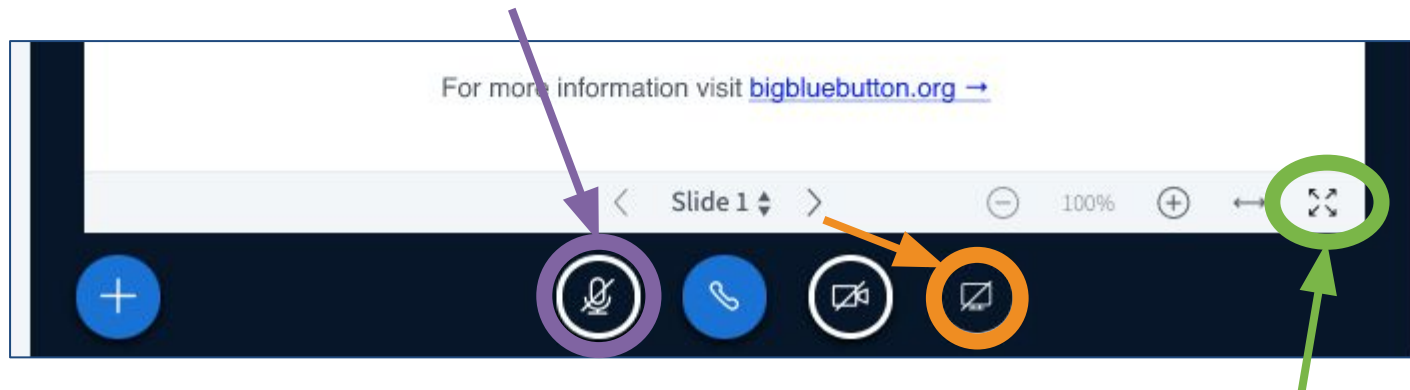

- Click to expand **make the shared screen full size**
- **Click to share your screen** (you can only see when made a presenter)

Survey Results from Session 2: Would you be interested in learning more?

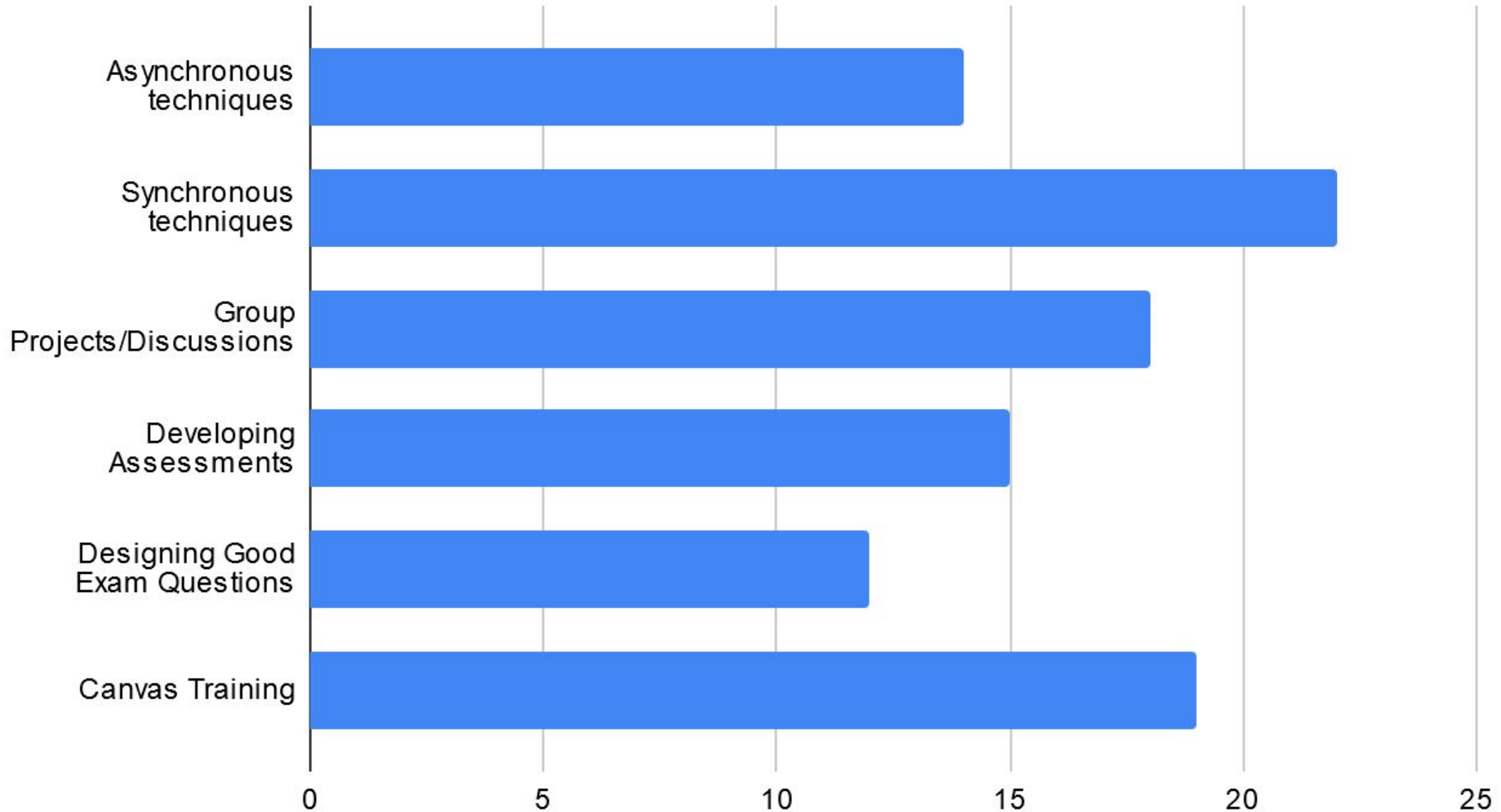

Survey Results from Session 2: Are you interested in training?

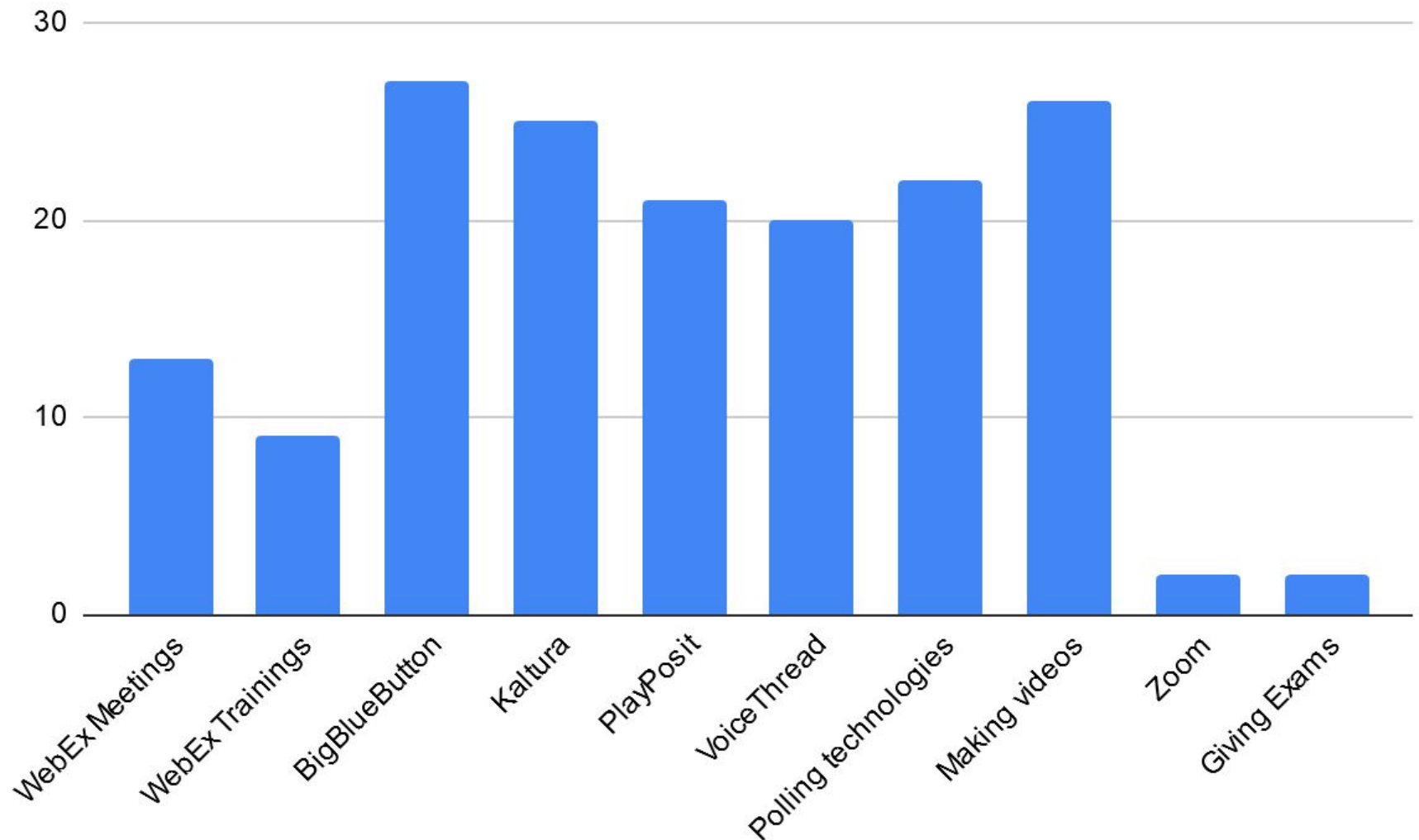



Jigsaw Activities

- Students in first groups complete an activity and then during re-grouping students share what they did in first
- Students each act as a piece of the puzzle necessary to create the whole picture
- You can use break-out rooms to organize this in an synchronous format



Activity

- Each “team” is going to have a piece of an article we emailed you all -
<https://go.rutgers.edu/smk3pjgk>
- We have made a Google folder with a separate document for each team -
<https://go.rutgers.edu/q5ac85xz>
- When we push you into the breakout rooms, **find your room number and click on the appropriate Google Document for assignment and questions**



Breakout Rooms Demonstration

- We are going to put you into Breakout rooms - select Microphone to move your audio to breakout room

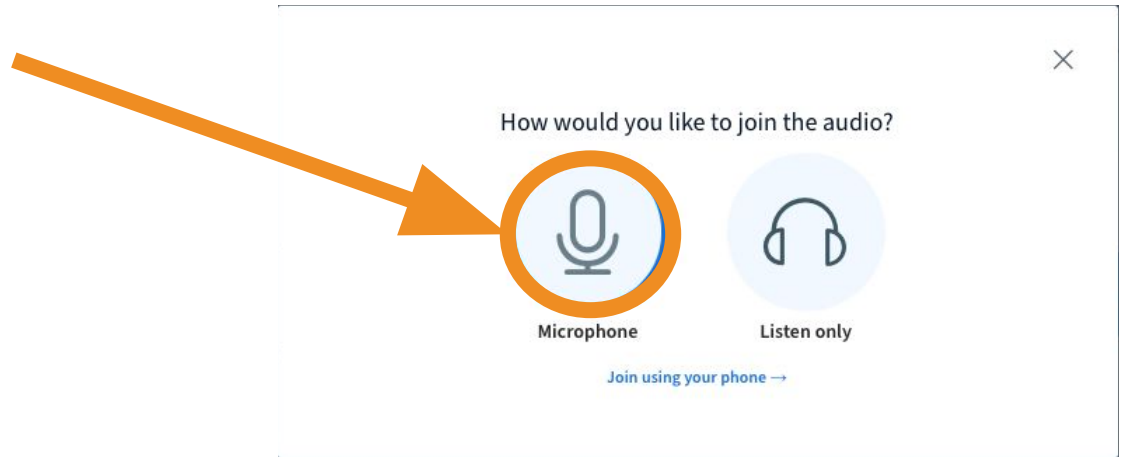

- The session will automatically end after

Report from Break-out Rooms



Poll Everywhere for Synchronous Sessions



- Provides different types of questions like word clouds or clickable images
- You can use for free ([Higher Ed license](#)) with up to 40 students

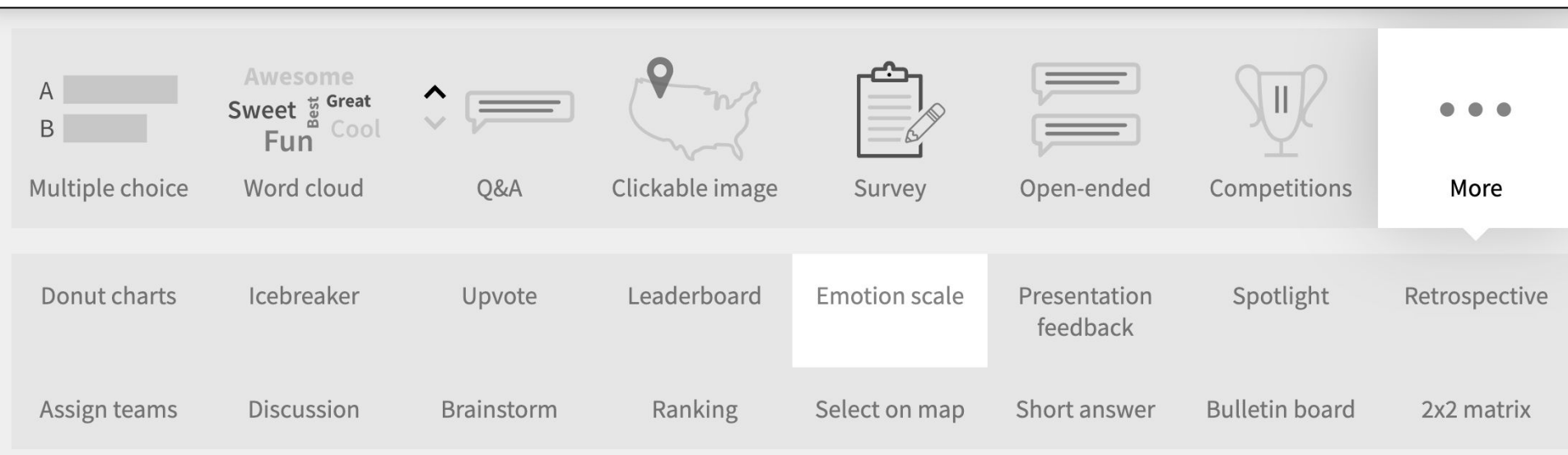

Poll Everywhere

If you could go anywhere in the world where would you go?



Start the presentation to see live content. For screen share software, share the entire screen. Get help at pollev.com/app

When poll is active, respond at PolleEv.com/cbifulco116

Text **CBIFULCO116** to **37607** once to join

How are you feeling about getting your course ready in the fall? Try to use single words, but you can submit more than once :)



Other Features of Canvas/Sakai Conferences: BigBlueButton

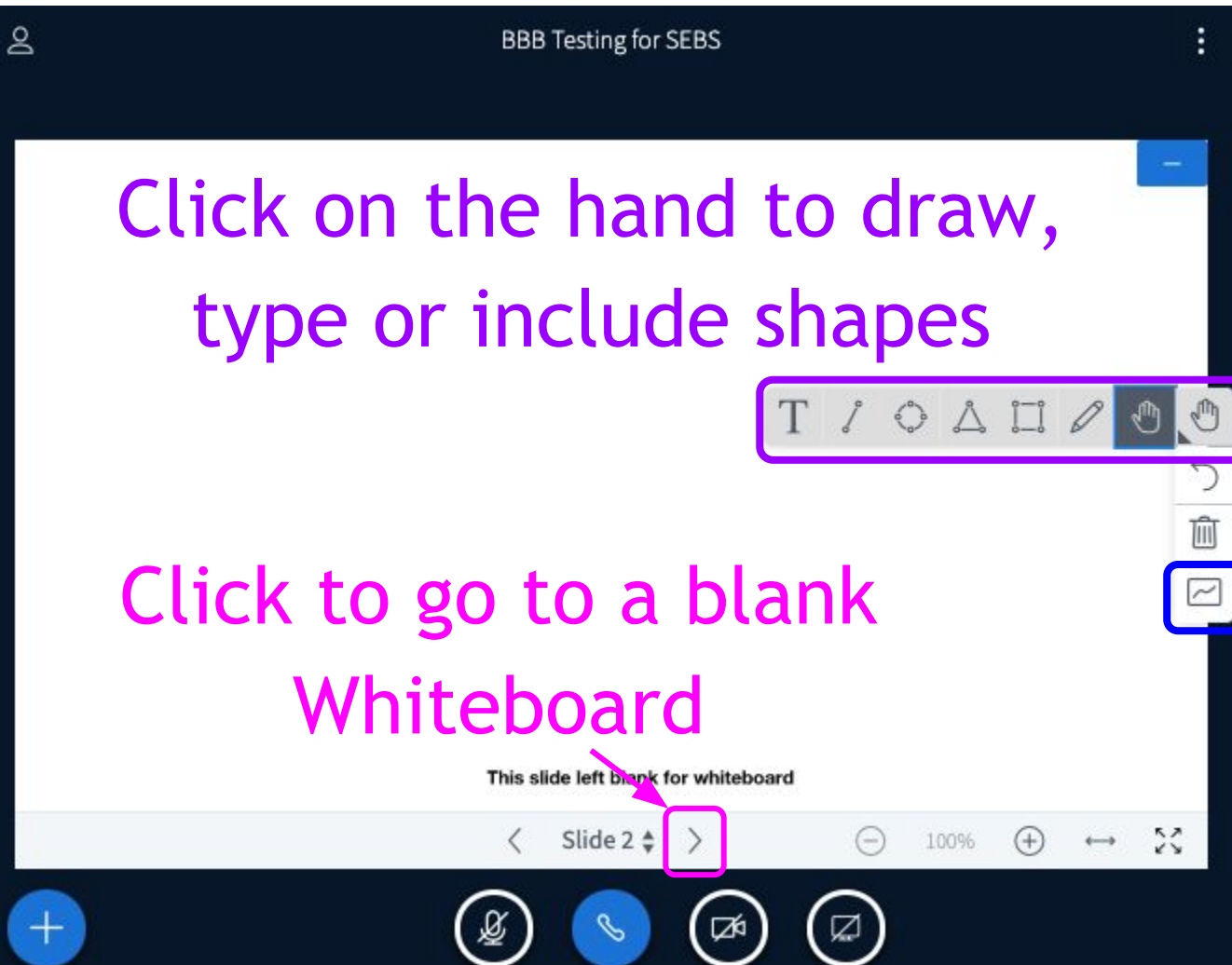

Allow everyone to draw on the Whiteboard



Click to go to a blank Whiteboard



Other Features of Canvas/Sakai Conferences: BigBlueButton

Polling gives you the option of just providing answer choices (so you don't have to write entire question)

Click the + to upload a presentation, share a video or start a poll

The image shows a screenshot of the BigBlueButton interface. On the left, a menu is open with the following options: "Start a poll", "Upload a presentation", and "Share an external video". A blue circle with a white plus sign (+) is highlighted in the bottom left corner, with a pink arrow pointing to it from the text "Click the + to upload a presentation, share a video or start a poll". The main area of the screen displays "This slide left blank for whiteboard" and "Slide 2". On the right, a "Polling" dialog box is open, showing options to start a poll: "Yes / No", "True / False", "A / B", "A / B / C", "A / B / C / D", and "A / B / C / D / E". Below these options, there is a "Custom poll" option with a text input field. The dialog box also contains the text: "Select an option below to start your poll." and "To create a custom poll, select the button below and input your options."

Hosting Videos in LMS

Canvas: 5GB Storage (Can be increased upon request)

Sakai: 1GB Storage (Can be increased upon request)

500 MB maximum upload

Limitation: Videos stored in LMS will not be auto captioned

Kaltura Walk Through

Canvas: <https://rutgers.mediaspace.kaltura.com>



The Kaltura Capture Desktop Recorder

If you've already installed Kaltura Capture, it will launch automatically.

Using Kaltura Capture for the first time?

[Download for Windows](#) | [Download for Mac](#)

PlayPosit Walk Through

- [Online directions for PlayPosit](#)



Canvas Training

- [Live workshops](#) on Canvas
- [Videos](#) that you can go through on your own
- [Canvas Help Desk](#) for those specific questions
- [Canvas Guides](#)



canvas

Canvas Commons

- Set-up modules with instructions for PlayPosit, VoiceThread, and other tools

The screenshot displays the Canvas Commons interface. At the top, the 'canvas commons' logo is visible, along with navigation tabs for 'Search', 'Shared', 'Imported', 'Updates (0)', and 'Favorites'. Below the navigation is a search bar with the placeholder text 'Search by title, name, institution or tag'. To the right of the search bar are dropdown menus for 'Latest' and a 'Filter' button. The search results section shows '119 results' and a filter for 'Rutgers University'. Four result cards are displayed in a row. The first three cards are for 'Library Tutorials: Health Science', 'Library Tutorials: Critical Thinking', and 'Library Tutorials: Communication', all marked as 'FEATURED' and associated with 'Rutgers University Libraries'. The fourth card is for 'PlayPosit Interactive Video', marked as 'FEATURED' and associated with 'Canvas Admin'. A purple arrow originates from the search bar area and points to the 'Commons' icon in the left sidebar.

Account
Dashboard
Courses
Calendar
Inbox
Search
Commons
Help

canvas commons Search Shared Imported Updates (0) Favorites

Search by title, name, institution or tag Latest Filter

119 results
Rutgers University X

RUTGERS University Libraries **FEATURED**
COURSE
Library Tutorials: Health Science
Undergraduate - Graduate
Rutgers University Libraries

RUTGERS University Libraries **FEATURED**
COURSE
Library Tutorials: Critical Thinking
Undergraduate - Graduate
Rutgers University Libraries

RUTGERS University Libraries **FEATURED**
COURSE
Library Tutorials: Communication
Undergraduate - Graduate
Rutgers University Libraries

playposit **FEATURED**
MODULE
PlayPosit Interactive Video
Undergraduate - Graduate
Canvas Admin

Designing Good Exam Questions

Our “[Writing Exam Questions that Measure Student Learning](#)” Workshop from April is posted on our [CTAAR Remote Teaching Community](#) Canvas site



Discussion

What is one thing you are unsure about?

(1 minute MAX per problem,
1 minute MAX for solutions)



Discussion

What is one thing you are stuck in developing your model course?

(1 minute MAX per problem,
1 minute MAX for solutions)



Discussion

What is one thing you are excited to implement?

(1 minute per tool or strategy)



Technical Questions?

Questions about Canvas? <http://canvas.rutgers.edu>

Questions about Sakai? sakai@rutgers.edu

Questions about Proctoring Technology?
proctoring@docs.rutgers.edu

Questions about other technology?
help@oit.rutgers.edu